

THIS DRAWING IS AN UNCONTROLLED COPY UNLESS STAMPED OTHERWISE

CONTRACTORS SHALL VERIFY JOB DIMENSIONS BEFORE ANY JOB COMMENCES.
 ALL SHOP DRAWINGS SHALL BE SUBMITTED TO THE SUPERINTENDENT AND MANUFACTURER
 SHALL NOT COMMENCE PRIOR TO THE RETURN OF DIMENSIONS SHOP DRAWINGS REVIEWED
 BY THE CONSULTANT FIGURED DIMENSIONS SHALL TAKE PRECEDENCE OVER SCALED. THIS
 DRAWING SHALL BE READ IN CONJUNCTION WITH ALL RELEVANT CONTRACT SPECIFICATIONS
 AND DRAWINGS COPYRIGHT OF THIS DRAWING IS VESTED IN HANDLE

General Notes

REFER ARCHITECTURAL DRAWINGS:

FACADE SETOUT AR1502-AR1507
 PRECAST SETOUT AR1512-AR1517
 SCREEN SETOUT AR1502-AR1557
 SCREEN DETAILS AR6550-AR6554

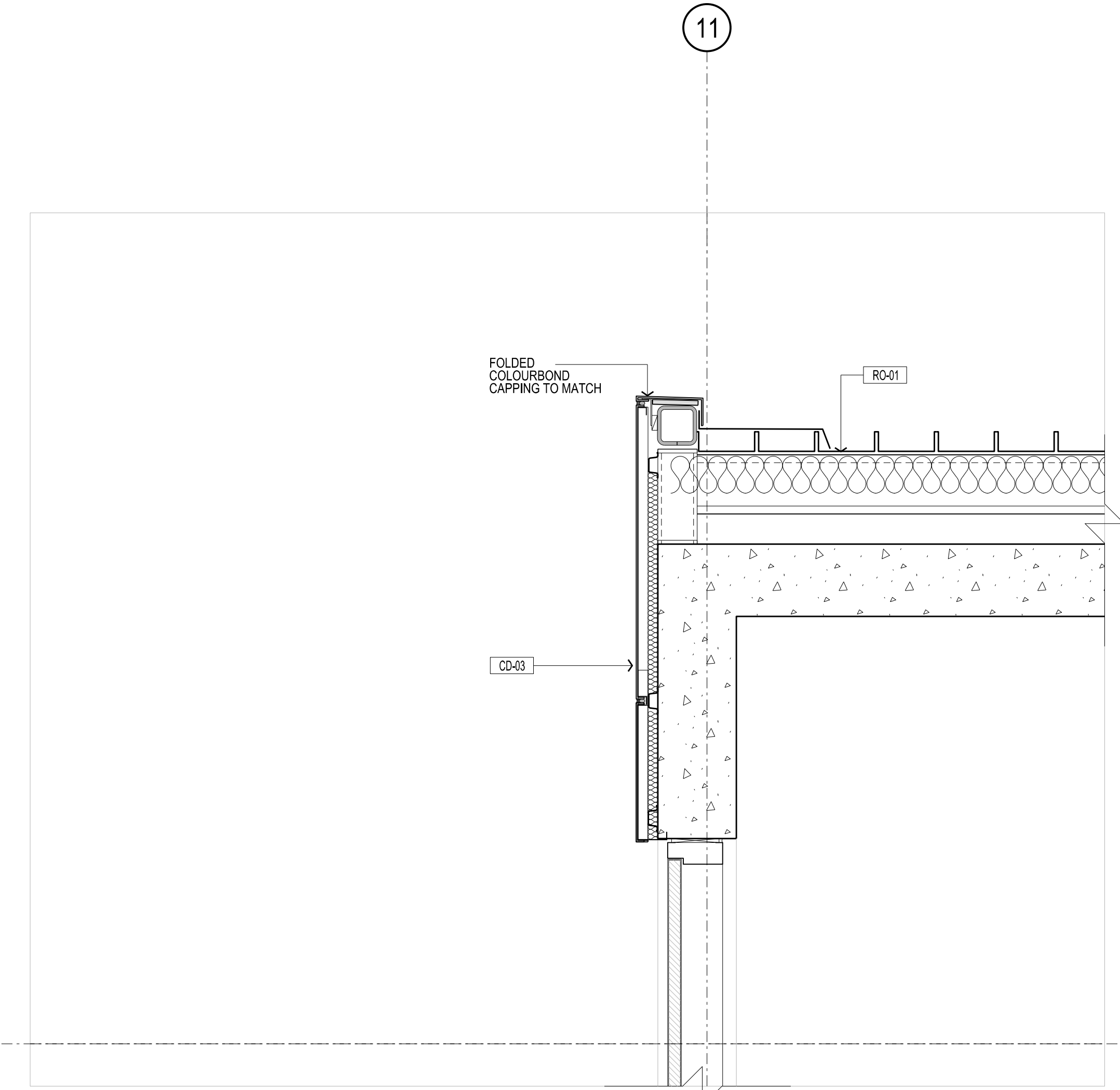

11 SECTION DETAIL
 3502 SCALE 1:10

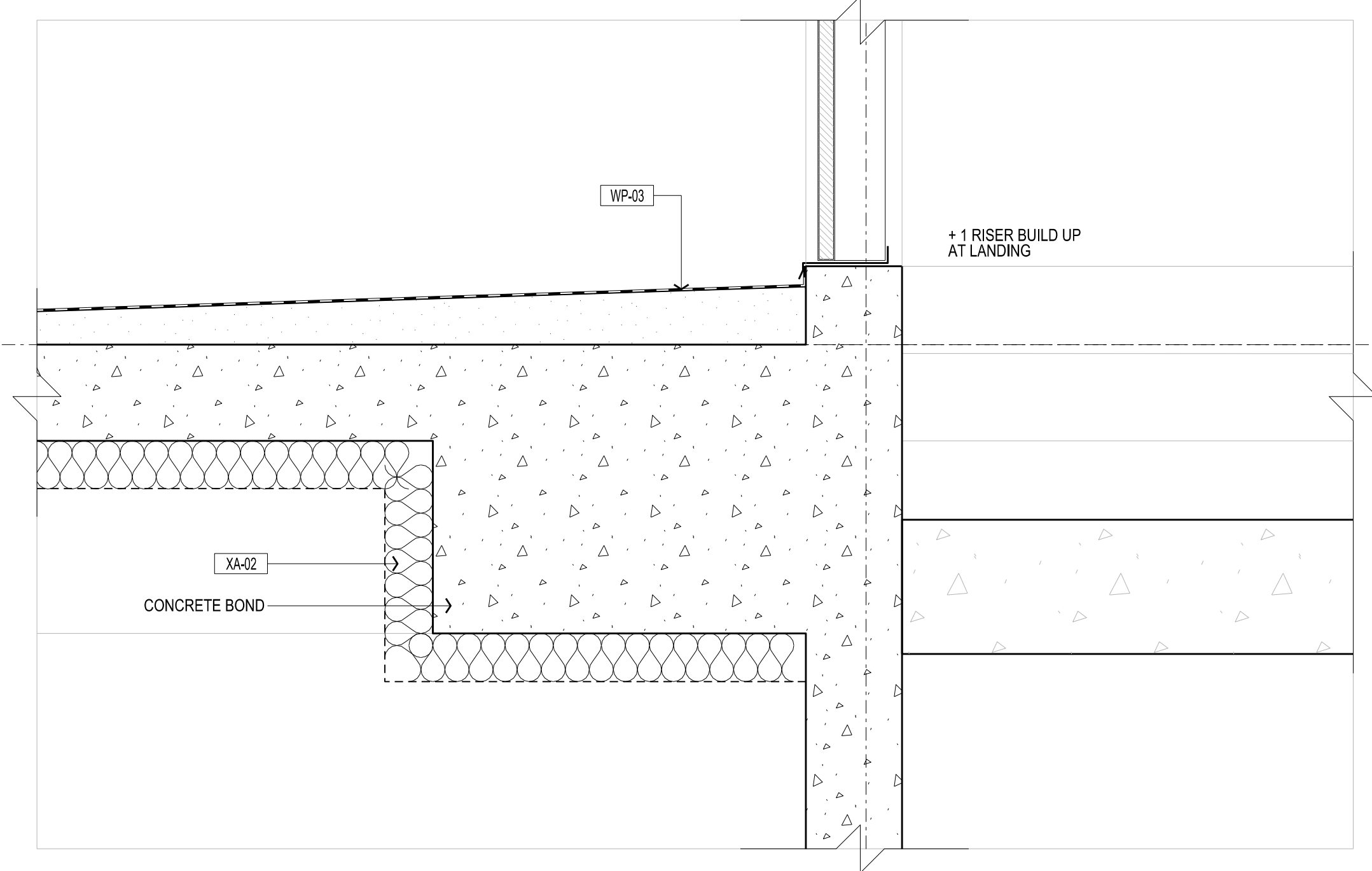

10 SECTION DETAIL
 3502 SCALE 1:10

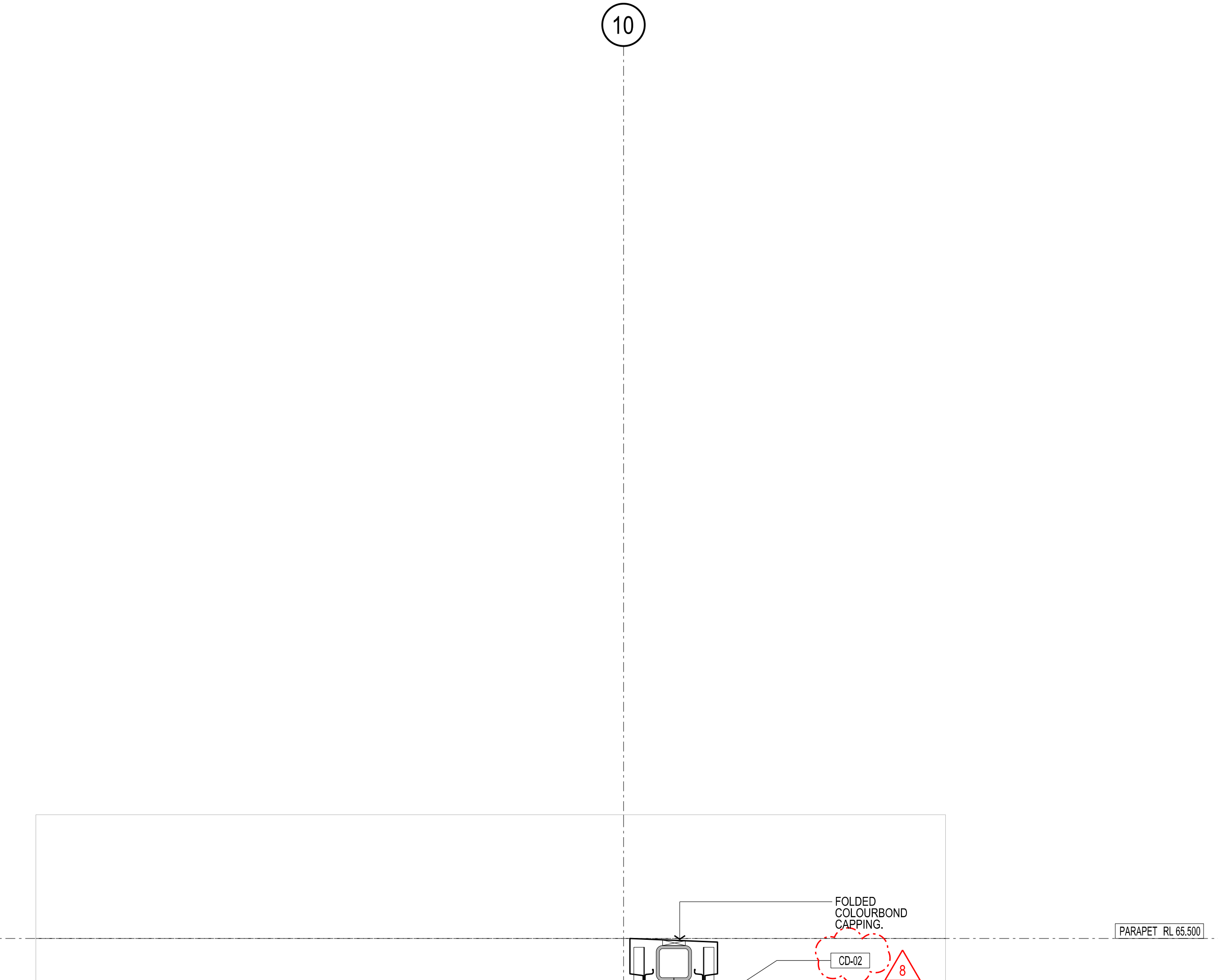

11 SECTION DETAIL
 3502 SCALE 1:10

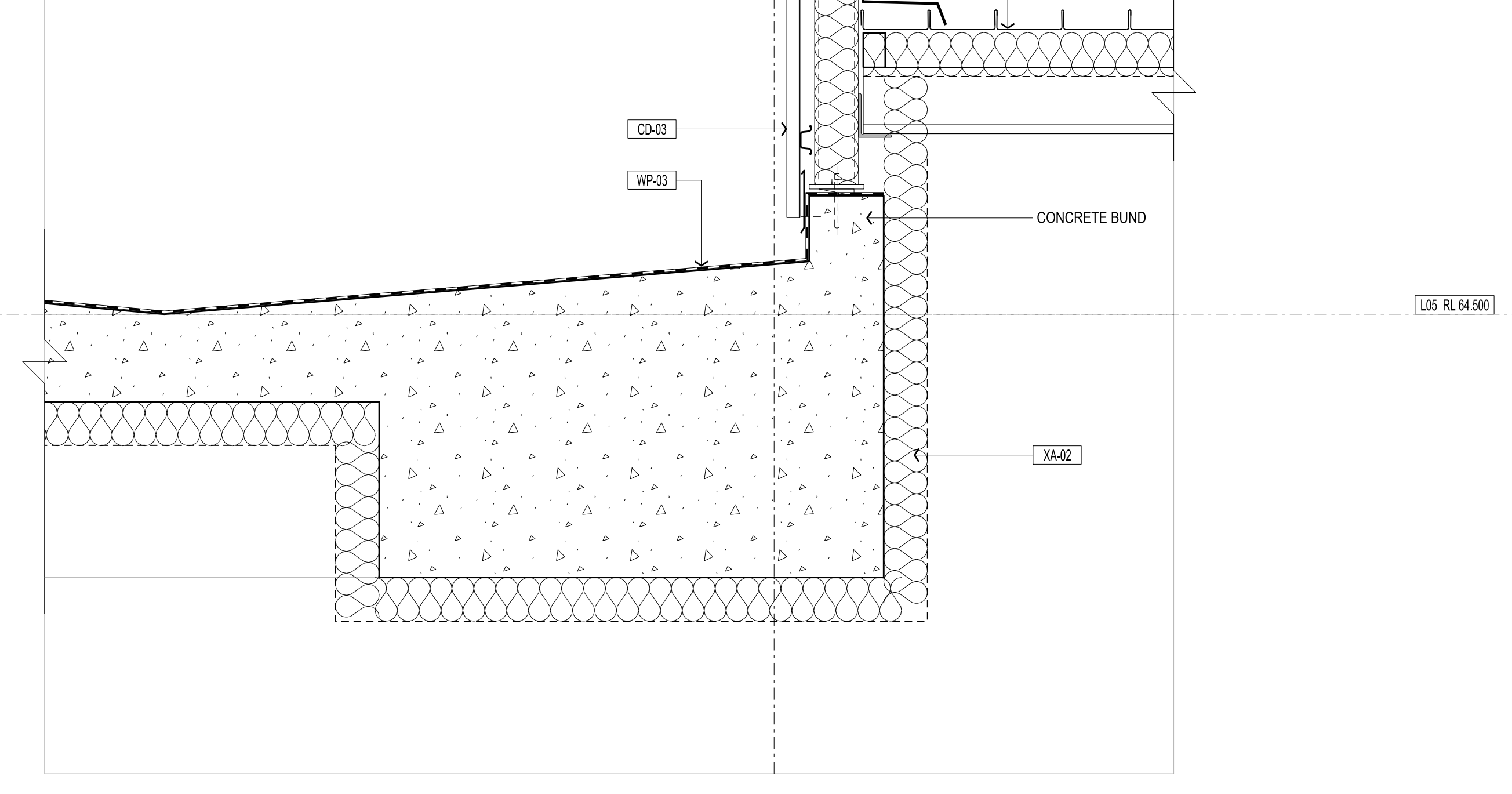

10 SECTION DETAIL
 3502 SCALE 1:10

Rev	Issue	Revision Description	And	Date
A	SG	ISSUED FOR CONSTRUCTION		21.06.13
04	SG	TENDER ISSUE		16.04.13
03	SG	VALUE MANAGEMENT ISSUE		28.03.13
02	SG	PRECAST REVIEW		21.03.13
01	SG	100% CD - TENDER ISSUE		07.09.12



NADAAA
 NADAAA
 1520 Washington Street No.2 Boston Massachusetts 02118 USA
 Telephone +1 617 442 8232
 Facsimile +1 688 442 1417
 Email nadaaa@nadaaa.com

John Wardle Architects
 25 Rokeby Street, Collingwood, Victoria 3066 Australia
 Tel: +61 3 8662 0400 www.johnwardlearchitects.com
 © 2012 John Wardle Architects ABN 83 006 814 268

Client **University of Melbourne Parkville Campus**

Project **Faculty of Architecture Building and Planning**

Title **SECTION DETAILS SHEET 17**

Project No.	0913	Scale	1:10 @ A0 1:20 @ A2
Drawing No.	AR6116	Revision	A

Date	Dec 2011	Dwn	-	Co-Ord	-	Chk	-
------	----------	-----	---	--------	---	-----	---

FILENAME - SFILES
FOR CONSTRUCTION